



STATE OF NORTH CAROLINA
DEPARTMENT OF TRANSPORTATION

PAT McCRORY
GOVERNOR

ANTHONY J. TATA
SECRETARY

April 8, 2014

Addendum No. 1

Contract No.: DA00195

TIP No.: N/A

WBS No.: 3701.3.18

County: Bertie

Renovation of Ornamental Plantings in Highway Rights of Way in Windsor, North Carolina

To Whom It May Concern:

Reference is made to the proposal previously furnished for this project.

The following revisions have been made to the proposal:

Title Sheet, has been revised to specify the cell pack size for Line 7 – White Sweet Alyssum. Please void the existing Title Sheet in the plans and staple the revised Title Sheet thereto.

Plan Sheet 5, "Mowing Limits Detail" has been included to illustrate the areas to be mowed along US 17 & US13. Please insert Plan Sheet 5 in the original set of plans.

Sincerely,

A handwritten signature in black ink, appearing to read "W. B. Hobbs", with a long horizontal flourish extending to the right.

W. B. Hobbs, PE
Division Project Manager

WBH/ces
Attachment

cc: S. D. Baker, PE
P. P. Mansfield

HIGHWAY LANDSCAPE DEVELOPMENT PROJCT

STATE OF
NORTH CAROLINA
DEPARTMENT OF TRANSPORTATION

COUNTY OF BERTIE
TOWN OF WINDSOR
US17/13

2004 American Standard
for Nursery Stock

2012 NCDOT Standard
Specifications

NC Department of
Transportation
DA00195
Enhancement Planting Project
Bertie County, Windsor, NC

SCHEDULE OF QUANTITIES

LINE	SECTION	DESCRIPTION	QUANTITY	UNIT
1	800	MOBILIZATION	1	LS
2	1105	TEMP TRAFFIC CONTROL	1	LS
3	1670	NELLIE R. STEVENS HOLLY, B&B, 6', FULL	10	EA
4	1670	CARISSA HOLLY, #3 CONT., 15-18" SPREAD	26	EA
5	1670	BLUE CHIP JUNIPER, #3 CONT., 15-18" SPREAD	22	EA
6	1670	RUBY LOROPETULUM, #3 CONT	14	EA
7	1670	WHITE SWEET ALYSSUM, CELL PACK* (SEE BELOW)	225	EA
8	SP	MONTHLY WARRANTY WORK	36	EA
9	1670	MULCH FOR PLANTING	50	CY
10	1670	WATER FOR PLANTING	3	M/G
11	SP	MULCH AFTER PLANTING	50	CY
12	SP	WATER AFTER PLANTING	15	M/G
13	SP	TOPSOIL	65	CY

*CELL PACK - 36 PLANTS (CELLS) PER FLAT (APPROX. 10.75" X 21.25" FLAT SIZE)

T.I.P. #	N/A	STATE PROJECT VBS #	3701.3.18	SHEET #	1	SHEET # TOTAL	4	DIVISION	1
FED. PROJ. #	N/A	DESCRIPTION	HIGHWAY LANDSCAPE DEVELOPMENT PROJECT						

DETAIL B MOWING LIMITS

US 13 & 17 N. BYPASS

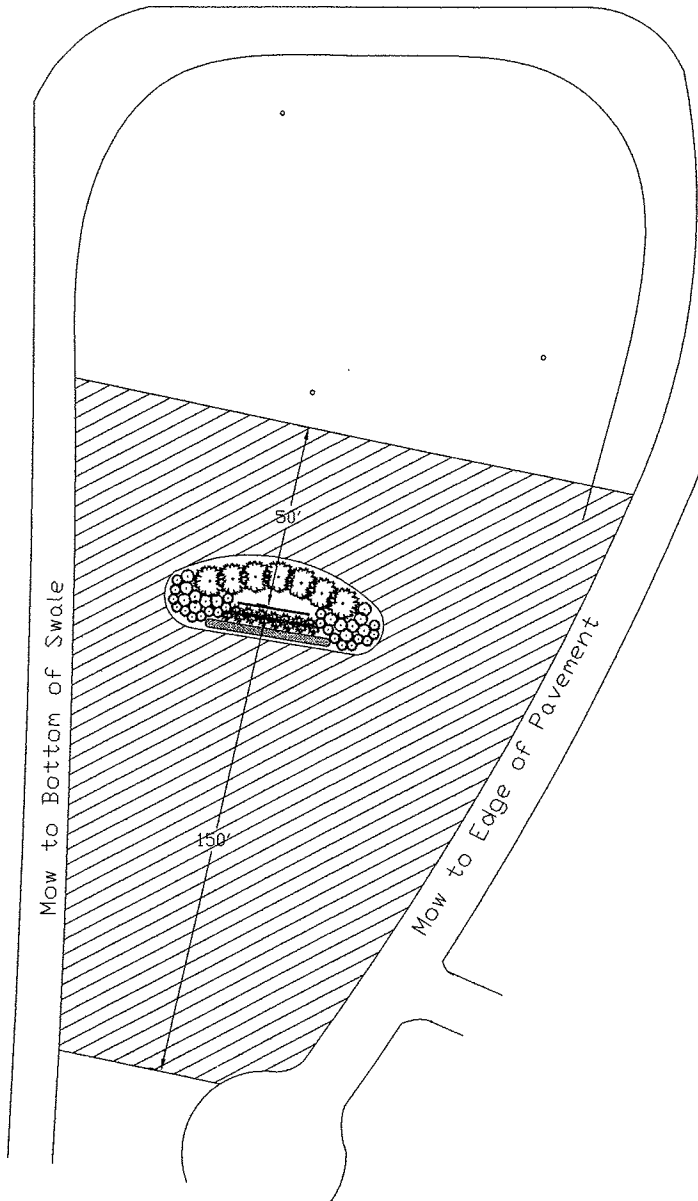

DETAIL A

On US13 Bypass, mow from edge of pavement to edge of pavement on US13 Business.

Mow 10' behind sign bed and from the front of the sign to the edge of pavement.

Inside the mowing pattern, mow or weed eat to the bottom of the ditch.

DETAIL B

On US17 Bypass, mow from bottom of the swale to the edge of pavement at the cul-de-sack and along the side street.

From the Sign, mow 150' in front and 50' behind.

DETAIL A MOWING LIMITS

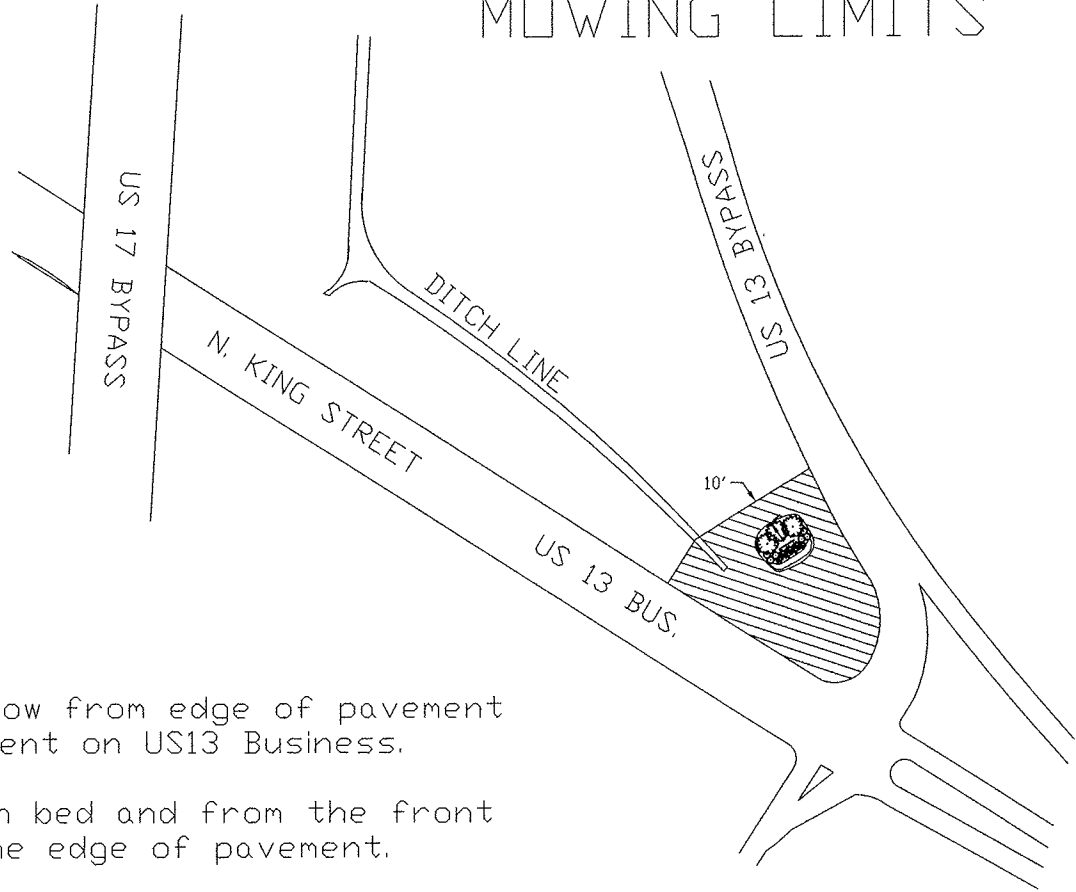

2004 American Standard
for Nursery Stock

2012 NCDOT Standard
Specifications

NC Department of
Transportation
DA00195
Enhancement Planting Project
Bertie County, Windsor, NC

T.I.P. #	STATE PROJECT VBS #	SHEET #	SHEET # TOTAL
N/A	3701.3.18	5	5
FED. PROJ. #	DESCRIPTION	DIVISION	
N/A	HIGHWAY LANDSCAPE DEVELOPMENT PROJECT	1	